

INSTALLATION NOTES

1. Tool kit required

- I Safe Power Tool
- li 10 mm spanner for end power feed lug bolts
- lii 2 off 13 mm spanner for centre feed lug bolts and irder clamps
- lv screwdriver
- V 7 mm spanner for collector shoe lead

2. Attention to the following will ensure a trouble free system

- I correct alignment of support
- li ensure that conductor joints are not against hanger clamps
adequate clearance must be allowed for expansion and contraction.
- lii wherever possible use the standard bracket pitch. This will
avoid conductors joints fouling support brackets.
- lv correct alignment of collector with conductor bars.
- V ensure that all power cable connections are flexible to allow
for conductor movements due to expansion and contraction. If in doubt mains cables should be terminated
in a junction box and separate flexible leads (possibly two)
used for connections to the conductor feed points.
these can be supplied on request.

3. Expansion assembly

- I expansions assembly air gaps must be set to suit site
conditions. See later instructions.

MOUNTING DETAILS

Cluster mounting

Not recommended for use outdoors

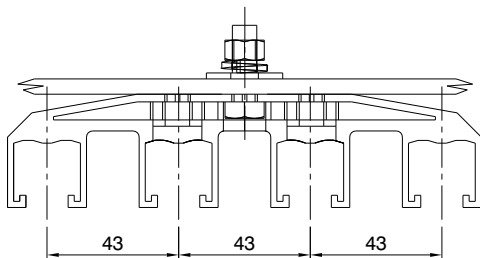

Space mounting

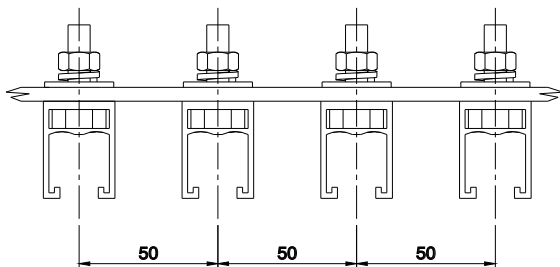

**Recommended for installations outdoors
And indoor contaminated environments.**

SAFE POWER-M CONDUCTOR SYSTEM NOMENCLATURE



SINGLE CONDUCTOR.



CONDUCTOR JOINT.



EXPANSION SECTION.

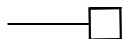

END CAP.

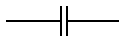
ISOLATING SECTION
ISOLATION =
INSULATING MATERIAL.

INDICATING LAMP

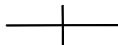

HANGER CLAMP.



ANCHOR POSITION.



POWER FEED.

ISOLATING SECTION.
ISOLATION = AIR GAP.

COLLECTOR.

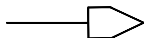

SWITCH FUSE.

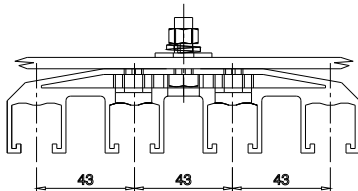
HANGER CLAMP FITTING Drill 9mm dia holes for hanger

Fix support brackets at the correct pitch Safe Power can supply support bracket if Required. Fit hanger clamps to support Brackets leaving final tightening of nuts until After conductors are fitted into hanger clamp.

Note :- fixing support bracket at a pitch that is divisibly into the bar length will always ensure that the joint positions do not foul the support brackets.
Purpose made brackets come complete with all Necessary fixing holes and easy hanger clamp Installation with slide in slots.

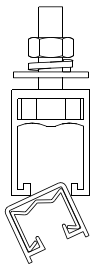
FITTING CONDUCTOR INTO HANGER**ANCHOR CLAMP ASSEMBLY**

After fitting conductor tighten steel nut to force the teeth on the clamp into the insulation

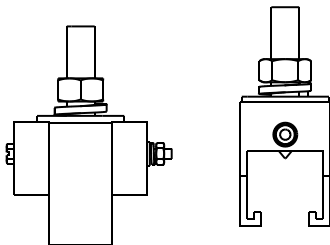

END CAP FITTING

**Ensure end cap fits correctly over bar insulating cover after
Fitting Cover stop bolt.**

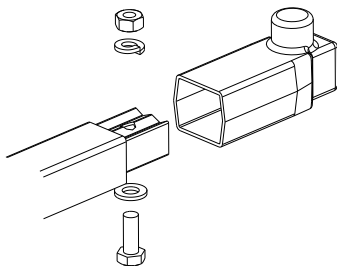

JOINT CONDUCTOR LENGTHS.

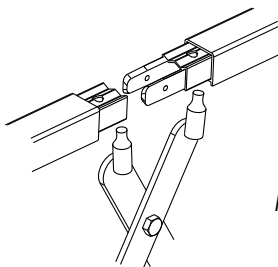

*Note :- stop on tool prevents
over tightening*



*Note :- Ensure connecting tool
Engages in joint hole properly as shown.*

JOINT COVER FITTING

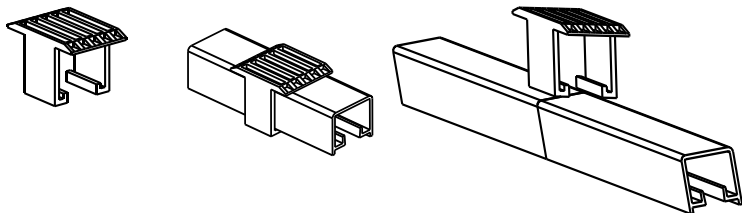

*Important :- internal 'v' must fit on bar
Between ends of insulation.*

END POWER FEED ASSEMBLY

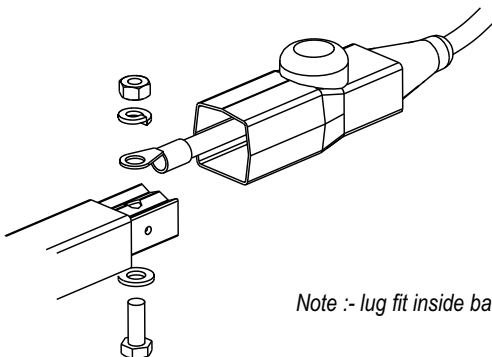

Note :- lug fit inside bar

END POWER FEED ASSEMBLY

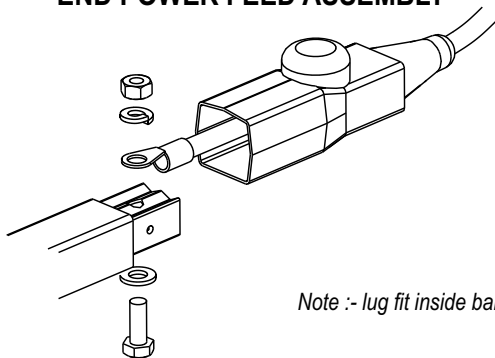

Note :- lug fit inside bar

CENTRE POWER FEED ASSEMBLY

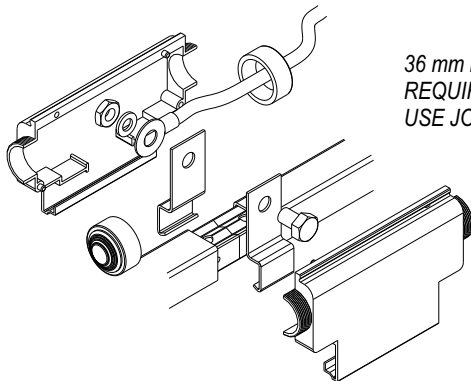

*36 mm LENGTH CUT OUT
REQUIRED IN COVER, OR
USE JOINT POSITION.*

Stainless steel Bands secure Cover halves.

TYPICAL POWER CABLE CONNECTION

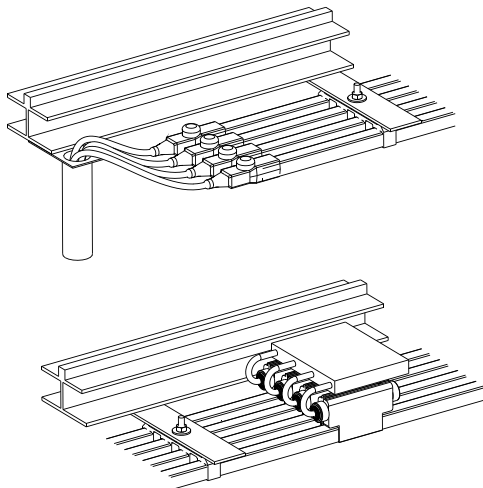

Note :- Always allow sufficient slack cable for expansion and contraction of conductors.

SYSTEM MAINTENANCE

1. Contact shoes should be checked for wear on a monthly basis until a wear pattern can be established. Failure to replace worn contact shoes will result in damage to the conductor, and reduce subsequent contact shoe life.
2. When checking for contact shoe wear, also check that all collector pivot points are free, and generally check alignment of the collector to the conductors.
3. The whole system should be checked on a regular basis to ensure that all insulation is intact. Repair if necessary.